

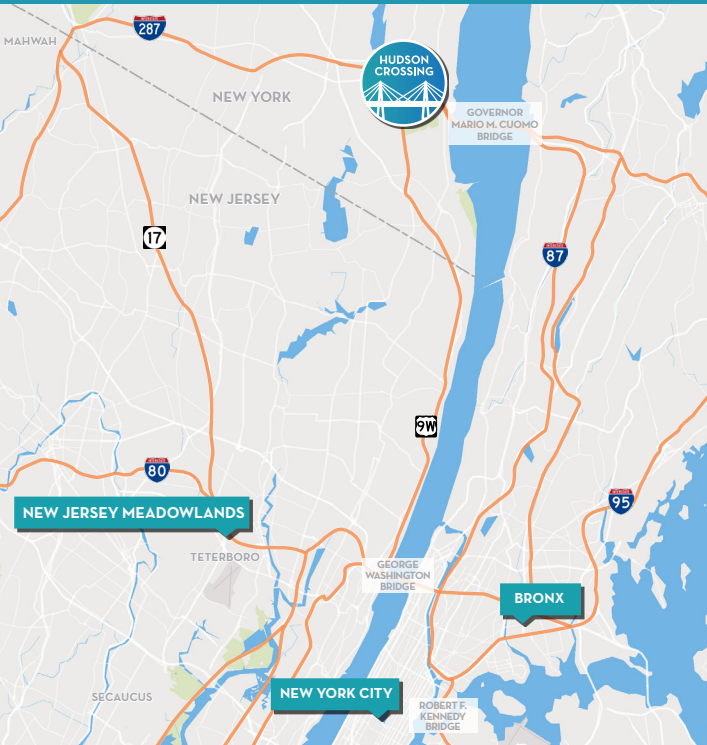

INDUSTRIAL SPACE FOR LEASE
200 CORPORATE DRIVE
 BLAUVELT, NEW YORK



8,057

Available SF



±24'

Ceiling Height



1

Dock Door



1

Drive-in Door

- » 50,070 SF total building size
- » 8,057 SF available
- » ±24' ceiling height
- » 1 dock door
- » 1 drive-in door

- » Power: 200 amp 277/480v
- » Car parking: 1 space per 1,000 SF



INDUSTRIAL SPACE FOR LEASE

200 CORPORATE DRIVE

BLAUVELT, NEW YORK 10913

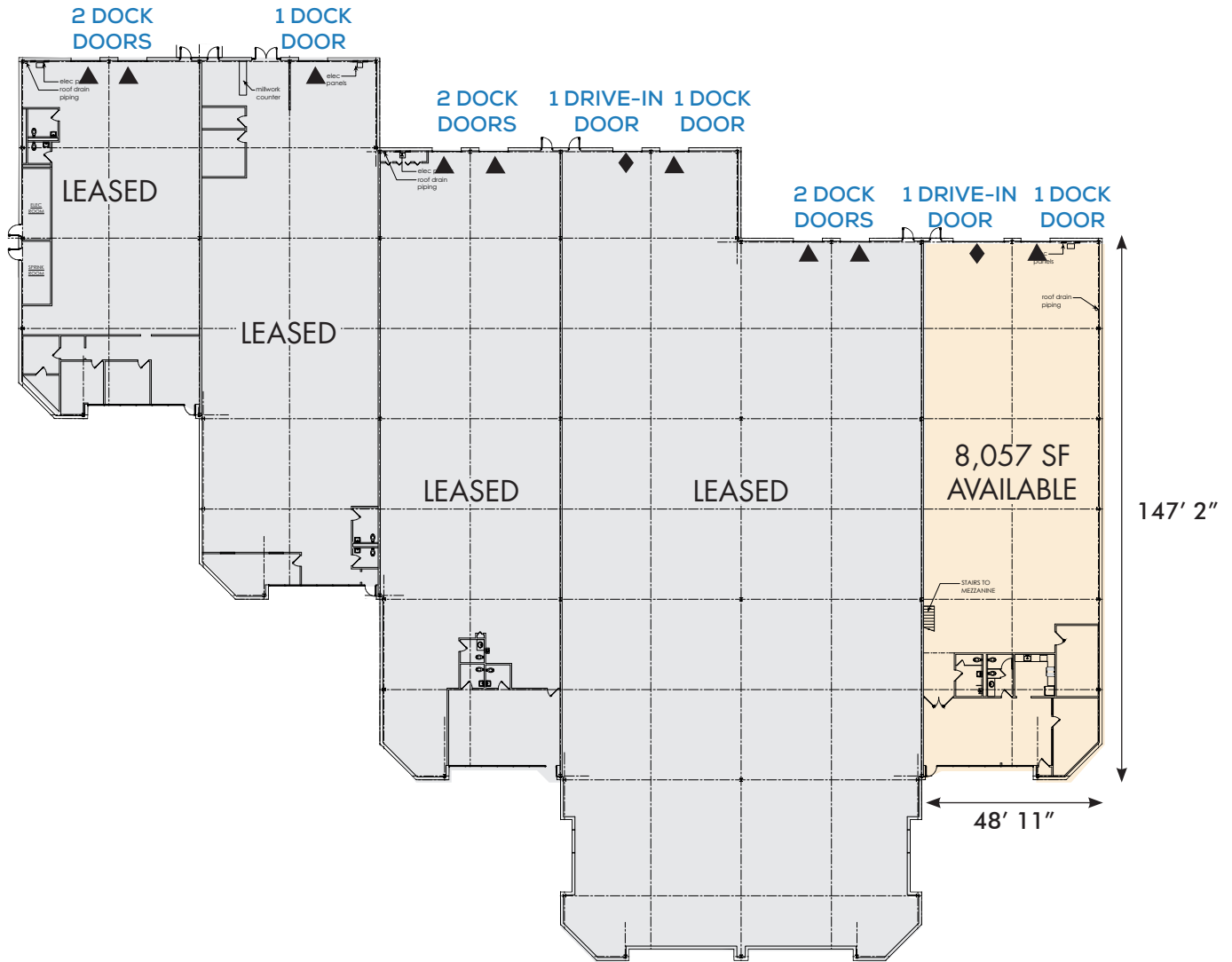

THOMAS F. MONAHAN

Vice Chairman
+1 201 712 5610
thomas.monahan@cbre.com

STEPHEN D'AMATO

Executive Vice President
+1 201 712 5616
stephen.damato@cbre.com

LARRY SCHIFFENHAUS

Executive Vice President
+1 201 712 5809
larry.schiffenhaus@cbre.com

CBRE



HUDSON-CROSSING.COM

© 2022 CBRE, Inc. All rights reserved. This information has been obtained from sources believed reliable but has not been verified for accuracy or completeness. CBRE, Inc. makes no guarantee, representation or warranty and accepts no responsibility or liability as to the accuracy, completeness, or reliability of the information contained herein. You should conduct a careful, independent investigation of the property and verify all information. Any reliance on this information is solely at your own risk. CBRE and the CBRE logo are service marks of CBRE, Inc. All other marks displayed on this document are the property of their respective owners, and the use of such marks does not imply any affiliation with or endorsement of CBRE. Photos herein are the property of their respective owners. Use of these images without the express written consent of the owner is prohibited.